

## CISTERN TANK OVERVIEW

### TOP DOWN VIEW

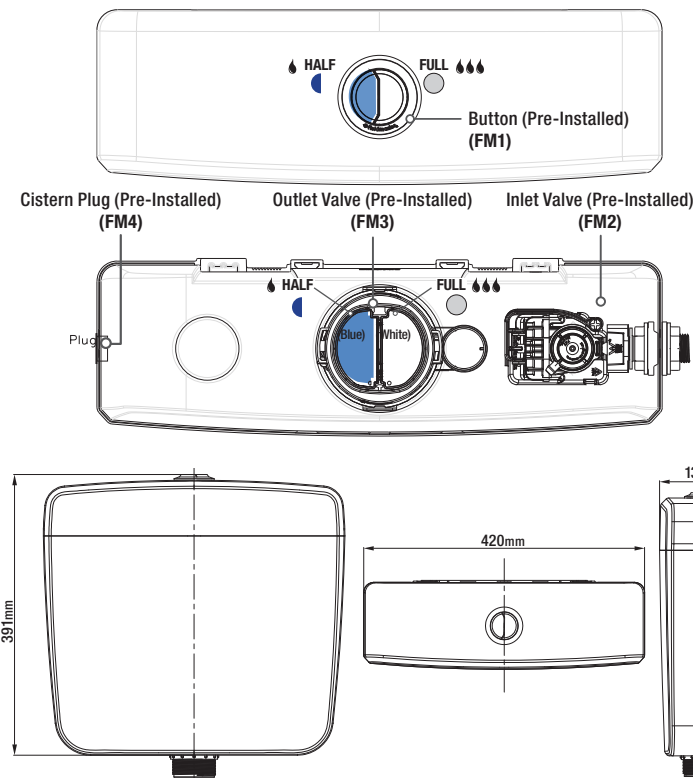

## PARTS OVERVIEW

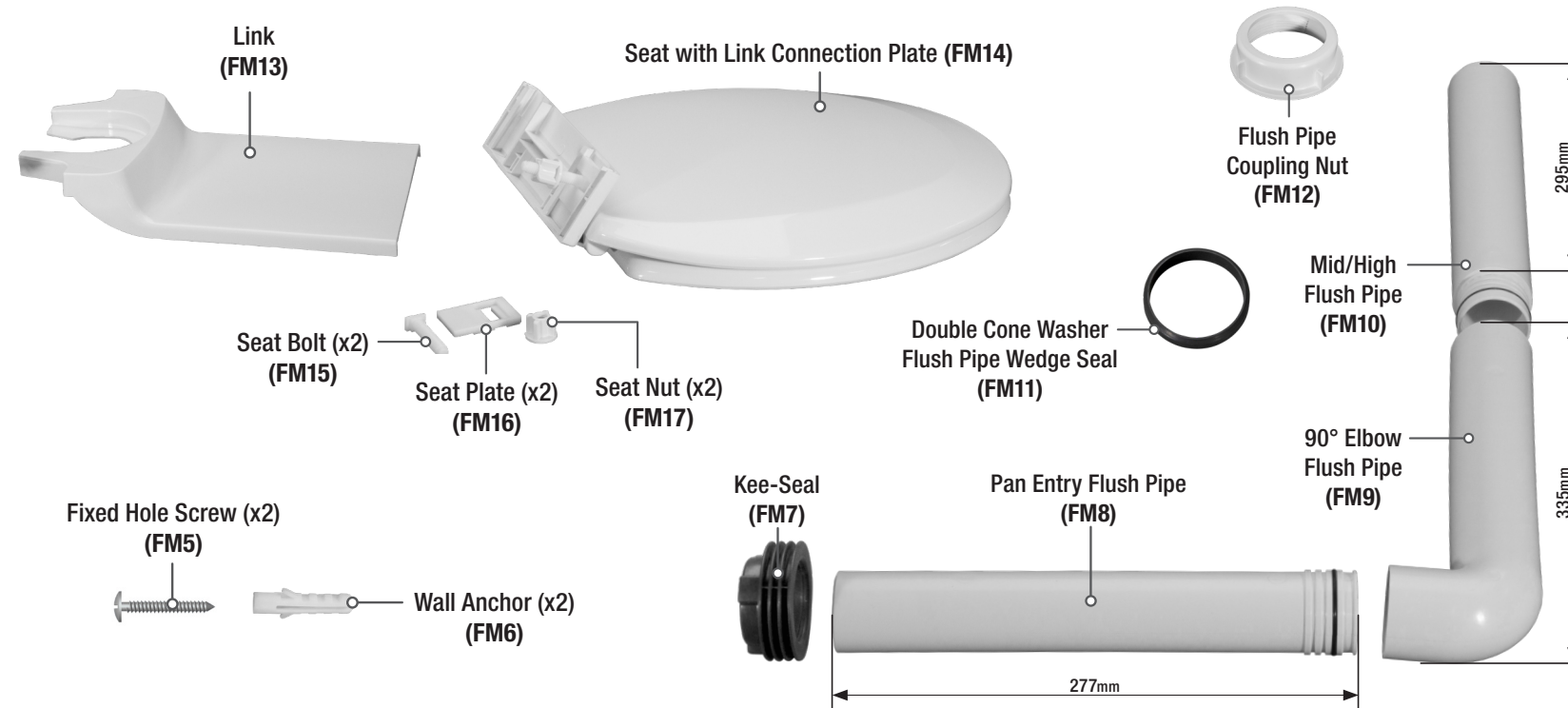

## PRE-INSTALLATION

### A: OPEN LID



## PRE-INSTALLATION

### B: FLUSH VOLUME CONVERSION

\*Fluidmaster Cistern pre-set flush volume settings = 4.5/3L system. For pairing to a 4.5/3L pan, no flush volume setting adjustment is required.

#### CONVERTING TO 6/3L OR 9/4.5L FLUSH VOLUME SYSTEM

B1: Remove black cistern tank spacer.

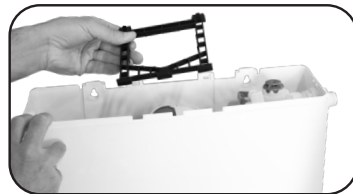

B2: Remove flush valve body & adjust full and half float settings per Flush Volume Conversion Table

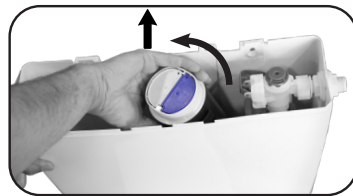

B3: Re-install flush valve body and black cistern tank spacer. Ensure proper full and half flush alignment.

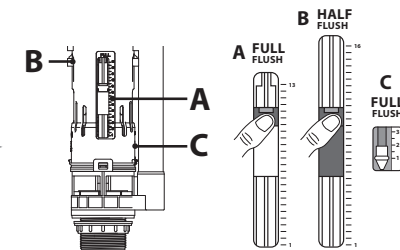
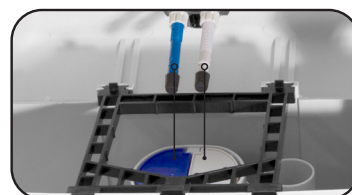

CISTERN FLUSH VOLUME CONVERSION SETTINGS

	4.5/3L	6/3L	9/4.5L
A Full Float #	7	3	1
B Half Float #	10	9	6
C Full Window #	1	1	1

NOTE:  
 (Blue) = Half Flush  
 (White) = Full Flush

## CHOOSE DESIRED INSTALL METHOD:

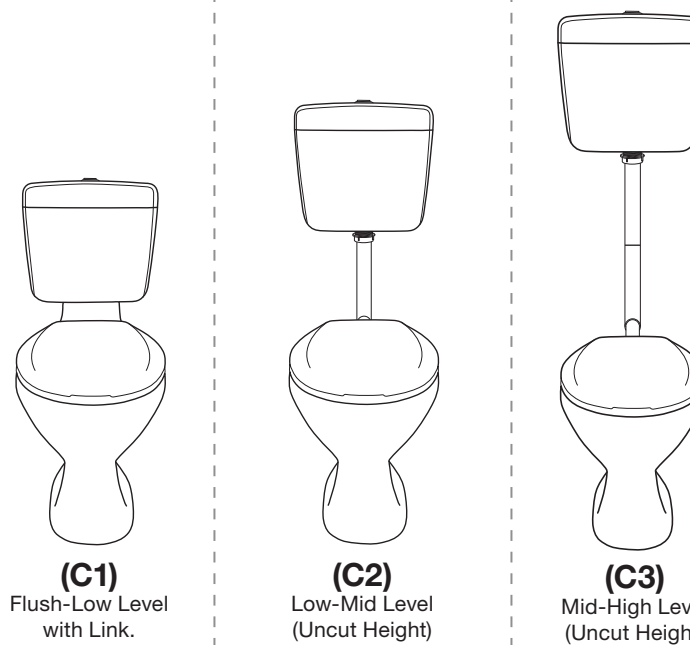

## STEP 1: MARK WALL FOR SCREW HOLES

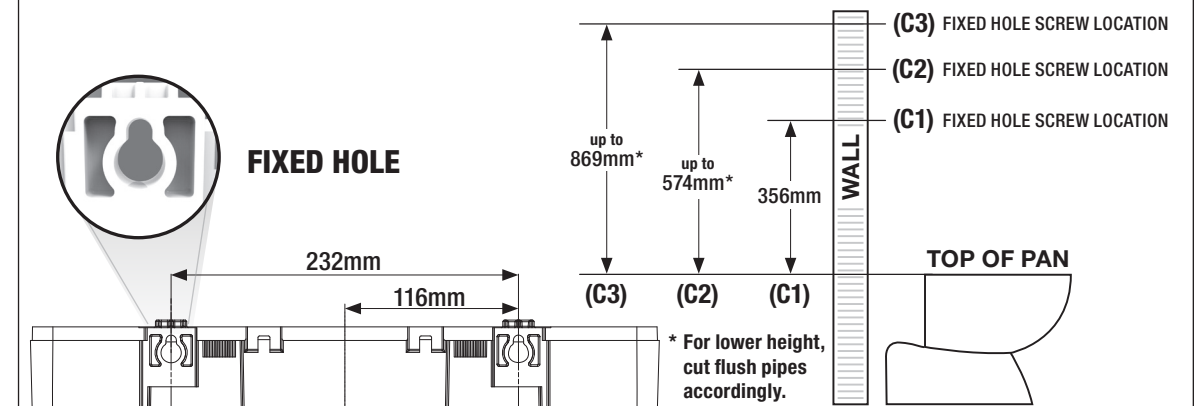

## STEP 2: SET SCREWS

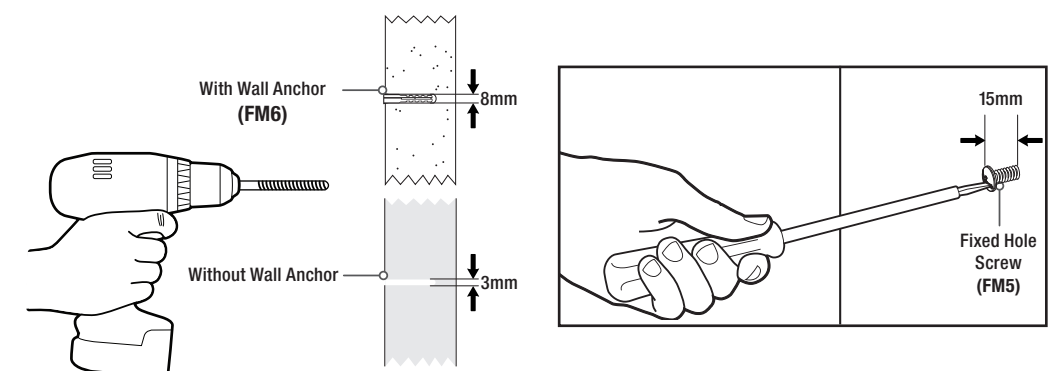

## INSTALLATION

### STEP 3: INSTALL FLUSH PIPES

**A:** Trim / Cut Flush Pipes as needed per install type.

**Note:** C1 Install type (with link) shown. For install types C2 or C3, no cutting required on 90° elbow (FM9) or Mid/High (FM10) Flush Pipes.

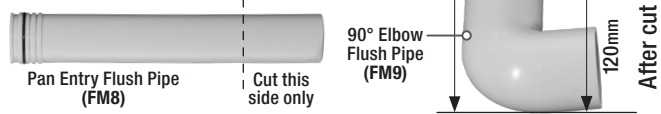

**B:** Lubricate kee-seal with soap and water. Insert flush pipes and connect to pan.

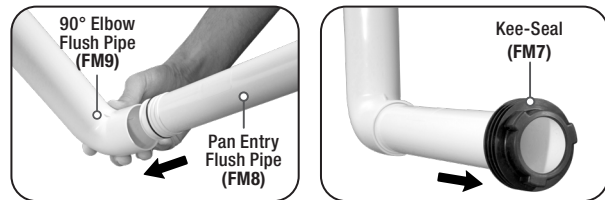

**C:** Fit Flush pipe coupling nut and double cone washer wedge seal onto flush pipe. Hand-tighten Flush pipe coupling nut and secure flush pipe to outlet valve shank. **DO NOT OVERTIGHTEN**

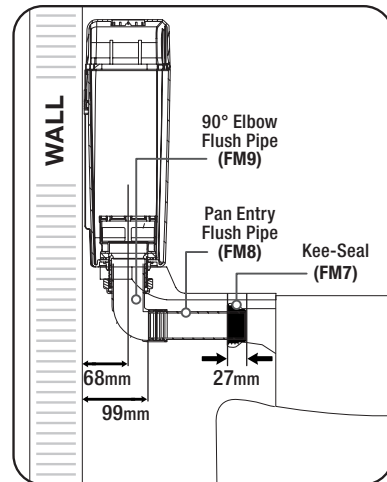

### STEP 4: HANG CISTERN TANK

FIXED HOLE



### STEP 5: WATER SUPPLY CONNECTION & FINE-TUNE TANK WATER LEVEL

**A:** Turn on water & flush water supply line.



**B:** Turn off water & connect water supply line to cistern with approved fittings. Hand-tighten only. **DO NOT OVERTIGHTEN.**



**C:** Turn on water & check for leaks.



**D. FLUSH THE CISTERN TO CHECK THE TANK WATER LEVEL**  
After the water stops filling the tank, the water level should be at the water line "WL-Side Entry" mark to ensure a proper flush.

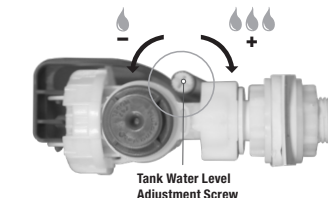
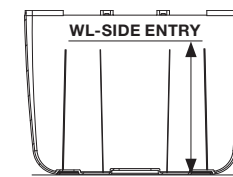

### STEP 6: ATTACH LINK (IF REQUIRED)

**A:** Secure link into position.

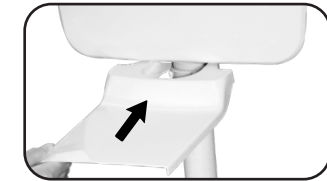

**B:** Set seat onto link to mark desired seat end point & cut point.

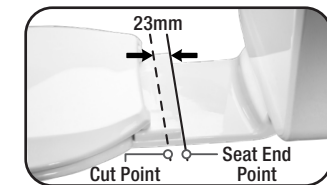

**C:** If cut required, cutting line guides reference on back of link as needed.

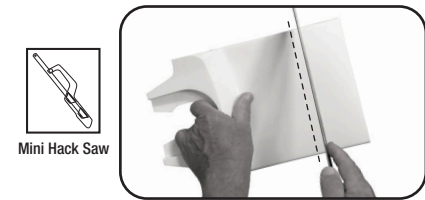

## INSTALLATION

### STEP 7: INSTALL SEAT

**A:** Insert Seat Bolt Plates in Connection plate (follow arrow guides).

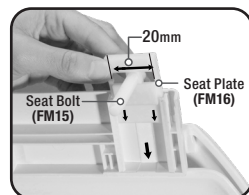

#### For Link Application

Insert link to seat connection plate. Set seat bolts into pan holes and hand-tighten seat bolt nuts.

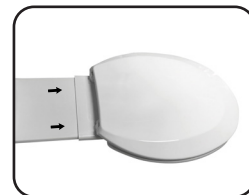

#### For Non-Link Application

Set seat bolts into pan holes and hand-tighten seat bolt nuts.

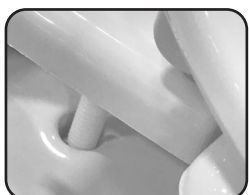

### STEP 8: ALIGN INLET VALVE

**Ensure PRO75 Side-Entry Inlet Valve Body & Float are Aligned / Levelled Correctly.**

#### Incorrect Position

**X** Inlet valve body / float should not touch the side walls of the cistern tank.

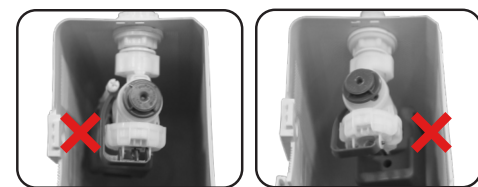

#### Correct Position

**✓** Inlet Valve body / float should be centered with cistern tank walls.



### STEP 9: ATTACH / RE-SECURE LID

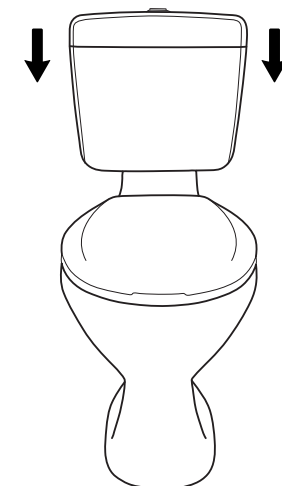

## TROUBLESHOOTING

#### IF THE INLET VALVE:

- DOES NOT TURN ON
- WON'T TURN OFF
- WON'T REFILL TANK

**REMOVE CAP AND CHECK FOR DEBRIS**

**A:** Turn off water supply.

**B:** Flush cistern.

**C:** Unsnap tank water level adjustment screw from cap arm.



**D:** Rotate cap 1/8 turn counterclockwise to unlock cap & pull out.

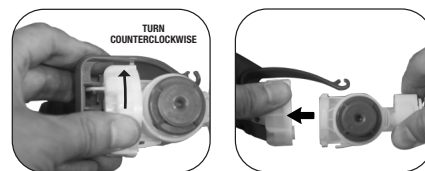

**E:** Cup your hand in front of uncapped valve to prevent splashing.



**F:** Turn water supply on and off a few times.

**G:** Turn water supply off.

**H:** Replace valve cap.

- Place cap assembly on valve body by engaging lugs & rotating 1/8 turn clockwise to locked position.

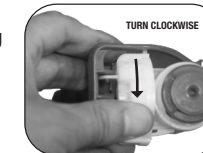

- Snap tank water level adjustment screw back on cap arm.



**I:** Turn water supply on.

\*Always use genuine Fluidmaster parts when installing or repairing. Fluidmaster will not be responsible or liable for use of non-Fluidmaster parts during installation or repair.

### WARNING



DO NOT USE IN-CISTERN DROP-IN TOILET BOWL CLEANERS CONTAINING BLEACH OR CHLORINE. Use of such products will: (1) RESULT IN DAMAGE to Cistern components and MAY CAUSE FLOODING and PROPERTY DAMAGE and (2) VOID FLUIDMASTER WARRANTY.  
DO NOT overtighten nuts or cistern/bowl may crack. Always use quality Fluidmaster parts when installing or repairing. Fluidmaster will not be responsible or liable for use of non-Fluidmaster parts during installation or repair.

### WARRANTY

Our goods come with guarantees that cannot be excluded under the Australian Consumer Law. You are entitled to a replacement or refund for a major failure and for compensation for any other reasonably foreseeable loss or damage. You are also entitled to have the goods repaired or replaced if the goods fail to be of acceptable quality and the failure does not amount to a major failure.

To present claims under this warranty, please contact your place of purchase or contact Fluidmaster Australia Holdings Pty Ltd. **NOTE:** Original proof of purchase required.

Warranty excludes incorrect installation. Installation shall be in accordance with AS/NZS 3500.1 and AS/NZS 3500.2 (Install with licensed plumber; any installation processed without licensed plumber will void warranty) 5 Year Parts Replacement / 1 Year Parts & Labor Warranty.

Only clean with soap and warm water to maintain quality finish. Do not use harsh chemical cleaners.

### ADDITIONAL QUESTIONS?

For installation assistance, contact our technical services department. **EMAIL**, or **CALL** our toll-free number.



Phone: +61 (0)3 8870 2555  
Toll Free: 1 800 931 166  
IN NEW ZEALAND Call 09 415 5585  
Email: salesau@fluidmaster.com  
Website: www.Fluidmaster.com.au

**Fluidmaster.**  
Fluidmaster Australia Holdings Pty Ltd  
6 / 100 New Street  
Ringwood, Victoria 3134  
Australia