

## Product Information/Specification Sheet

# Studor Maxi-Filtra (Active Carbon Filter designed to eliminate bad odours produced by the drainage system)

### Description

The Studor Maxi-Filtra is an active carbon filter designed to eliminate bad odours produced by the drainage system. The cartridge has a life expectancy up to 2 years dependant of installation. For use externally, it operates as a 2-way vent, filtering air in both directions. Particularly for use with septic tanks, the Maxi-Filtra may also be installed on open vents already existing or for new buildings where regulations insist on their inclusion within the building's drainage system.

For best results, the Studor Maxi-Filtra should be installed with Studor Air Admittance Valves (AAVs).

### Features

- Replaceable carbon filter cartridge.
- Prevents the release of foul air from the drainage system.
- Requires no specialist installation.
- Available in black ABS.

### Installation

- The Maxi-Filtra should be connected to the piping in accordance with Studor's installation instructions.

### Applications

The Maxi-Filtra is particularly suited for filtering bad odours resulting from the following applications:

- Septic tanks
- Outside installations
- Existing open vents
- Newly installed open vents required by local regulations

### Aluminium Cover (optional)

The Aluminium Cover provides increased protection to the Maxi-Filtra when it is installed outside. The cover is secured in place with adhesive tape. This provides increased protection from animals/ birds and the environment, i.e. inclement weather and the sun's ultra-violet rays.

### Warranty

The Studor products have a "Lifetime of System" warranty. Visit [www.studor.net.au](http://www.studor.net.au). Excludes the Active Carbon Filter.

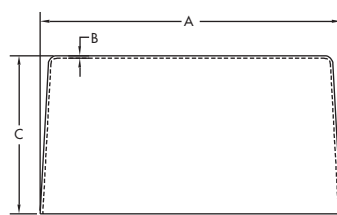

Aluminium Cover

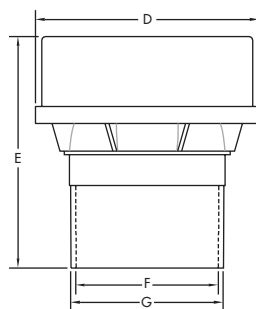

Maxi-Filtra

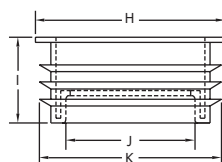

Connector

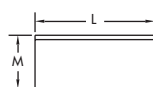

Cartridge

### Dimensions

Dimension	Metric (mm)	Imperial (inches)
A	Ø 175	Ø 6.89
B	1.5	0.06
C	92	3.62
D	Ø 130	Ø 5.31
E	135	5.16
F	Ø 83	Ø 3.27
G	Ø 89	Ø 3.50
H	Ø 111	Ø 4.37
I	50	1.97
J	Ø 75	Ø 2.95
K	Ø 106	Ø 4.17
L	Ø 70	Ø 2.75
M	31	1.22

Note: Dimensions for reference only

### Performance parameter

Temperature range	-20°C to +60°C -40°F to +150°F (ASSE)
-------------------	--

### Materials

Component	Material
Aluminium cover	Aluminium
Maxi-Filtra body	ABS
Connector	Rubber
Cartridge	Activated carbon

### Pipe sizes

AU/NZ
DN 80-100